

DATE REVISED	DATE FILMED	DATE REVISED	DATE FILMED	FED. ROAD NO.	STATE	FED. AID PROJ. NO.	SHEET NO.	TOTAL SHEETS
11-1-10					ARK.		76	203
				JOB NO.	110395			
				06830	330' UNIT		47073	

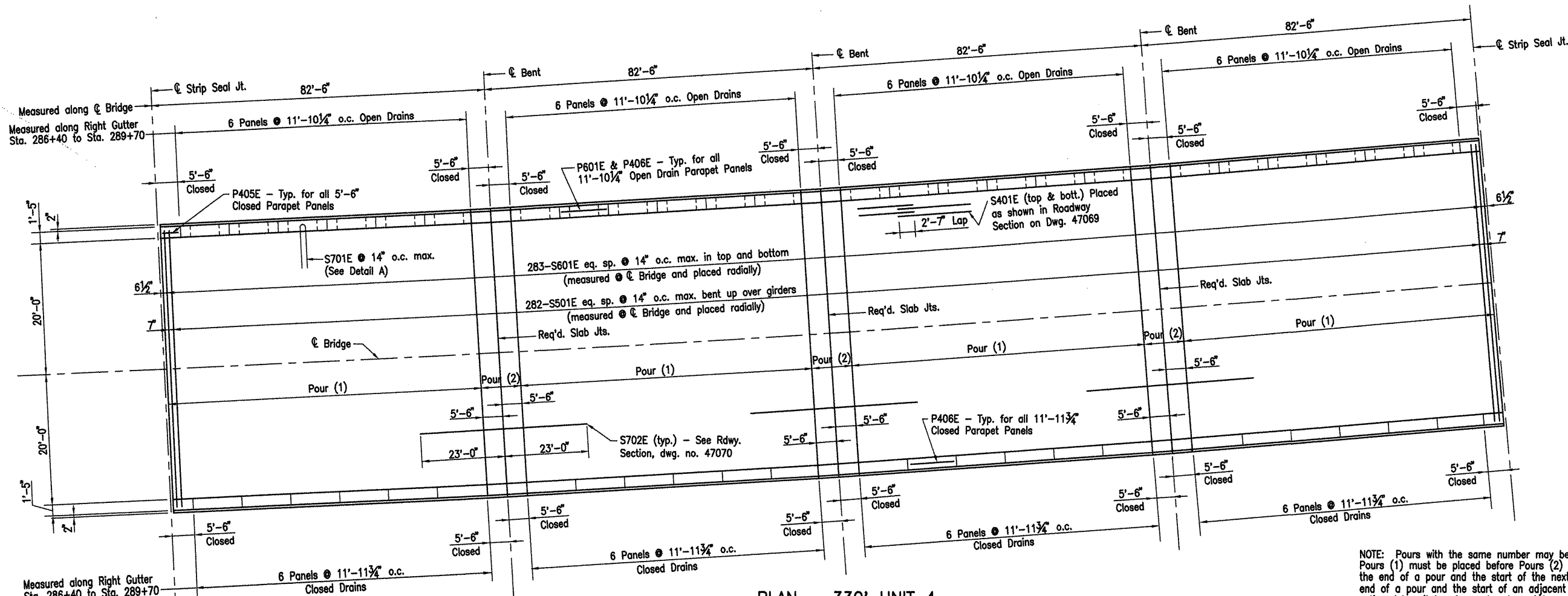

PLAN - 330' UNIT 4
N.T.S.
Sta. 286+40 to Sta. 289+70 (One Unit Required)

NOTE: Pours with the same number may be placed simultaneously or separately. All Pours (1) must be placed before Pours (2) can be placed. 48 hours shall elapse between the end of a pour and the start of the next pour. 72 hours shall elapse between the end of a pour and the start of an adjacent pour. Any railing pours made before the entire slab unit has been placed must be approved by the Bridge Engineer. Concrete in bridge superstructure shall be consolidated for the entire pour before any concrete has taken its initial set. This may require the use of a retarding agent. The Contractor must obtain approval from the Bridge Engineer for any deviations from the pouring sequence.

BAR LIST PER 330' UNIT

Sta. 286+40 to Sta. 289+70				Bending Diagrams (Dimensions are out to out of bars.)	
Mark	No. Req'd.	Length	Dia. Pin		
S401E	990	39'-1"	Str.		
S501E	282	43'-6"	3"		
S601E	566	42'-10"	Str.		
S701E	564	12'-10"	6"		
S702E	159	46'-0"	Str.		
P401E	712	6'-4"	2"		
P402E	712	5'-8"	2"		
P403E	168	5'-11"	2"		
P404E	168	3'-1"	2"		
P405E	96	5'-2"	Str.		
P406E	240	11'-6"	Str.		
P601E	120	11'-6"	Str.		
D401	128	9'-5"	2"		
D402	64	10'-4"	2"		
D403	96	11'-2"	2"		
D601	192	6'-9"	Str.		
D602	72	7'-4"	Str.		
D603	48	20'-7"	Str.		

Use 1/2" X 1" Type 3, 4 or 6 Joint Sealer. See Subsection 501.02(h) and 501.05(j). Backer rod shall not be installed. Joint Sealer shall be measured and paid for as Class S(AE) Concrete-Bridge. Slab Joints shall extend to the outside edge of the deck slab. Slab joints shall be installed before the parapet railing is poured. If slab joints are to be sawed, they shall be sawed as soon as the concrete has sufficiently set to allow sawing of the joint without damage to the slab. Slab joints shall be placed at all pouring sequence construction joints and required slab joint locations.

SLAB JOINT DETAIL N.T.S.

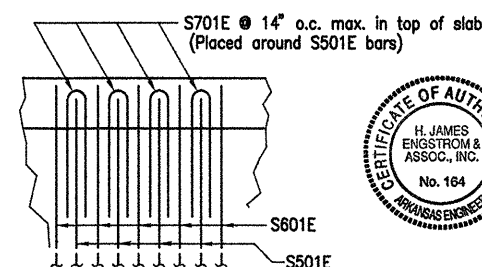

DETAIL A
N.T.S.

Revised Bar List by HJE/MM
GPT- 11-1-10

ALTERNATE NO. 1

DETAILS OF 284', 330' & 368' CONT.
PRESTRESSED CONCRETE GIRDER UNIT
(SHEET 12 OF 19)

WHITE RIVER STR. & APPRS.
(CLARENDON) (PH III) (F)
MONROE COUNTY

ROUTE 79 SEC. 13

ARKANSAS STATE HIGHWAY COMMISSION
LITTLE ROCK, ARK.

Engstrom/Modjeski and Masters, Inc.

DRAWN BY: JDB DATE: Sep. 10 FILENAME: b11039512_s11
CHECKED BY: WBC DATE: Sep. 10 SCALE: 1/16" = 1'-0"
DESIGNED BY: GPT DATE: Sep. 10
BRIDGE NO. 06830 DRAWING NO. 47073

BRIDGE ENGINEER